



TAB 42

Fargo, ND

TAB
42
BY EPIC

COMMERCIAL SPACE AVAILABLE

ADDRESS

4207 28th Avenue S, Fargo, ND 58104

PROPERTY DETAILS

Lease Rate	\$18/SF
CAM	\$6.50/SF
Total Space	11,000± SF
Space Available	1,200± SF
Lease Term	5 Years
Year Built	2022
Floors	1st & 2nd Floors
Style	Office
Fit-up Allowance	\$25/SF

Subdivided space available. Details and rates are subject to change at any time. Contact for more information.

701.866.1006

EPICCompaniesND.com

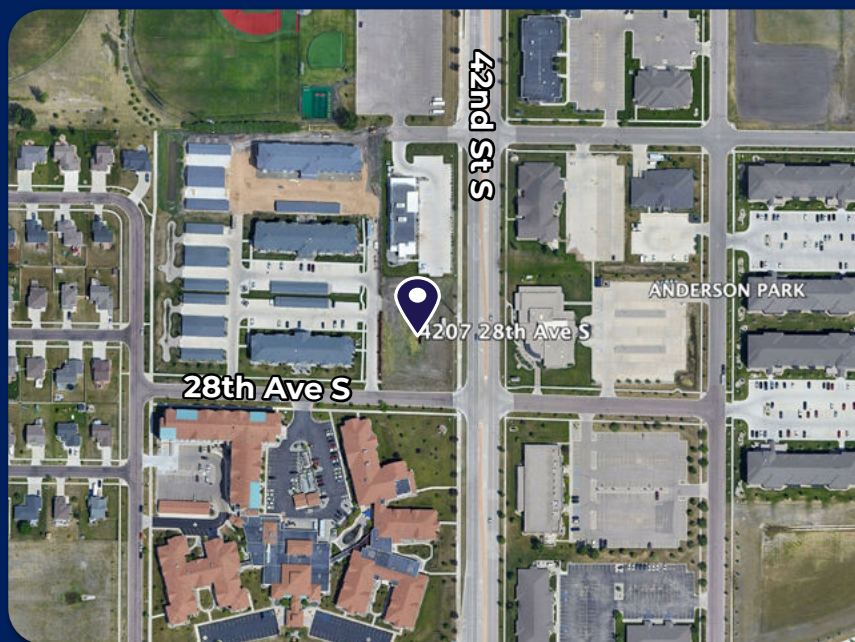

EC EPIC
COMPANIES
Investment • Development • Management



TAB 42

4207 28th Ave S, Fargo, ND 58104

1st Floor



2nd Floor

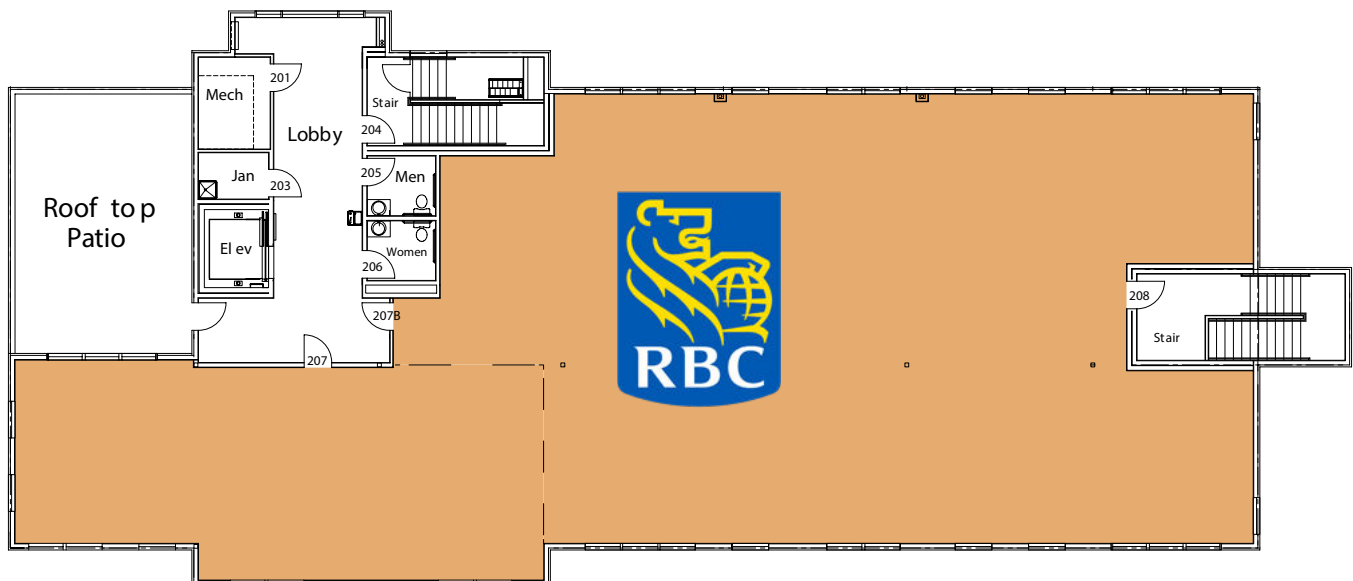



TAB 42 PROJECT OVERVIEW

4207 28th Avenue S, Fargo, ND 58104



OVERVIEW

TAB 42 is a commercial rental building in Fargo, ND. This space will provide an opportunity to serve any type of business. This property will include 2 stories of commercial space with a rooftop patio! TAB 42 will be completed summer 2022.

Features

- Digital Monument Sign
- Established Business District
- Spacious Parking Lot
- Rooftop Patio

Nearby Locations of Interest

- Bars & Restaurants
- Red River Zoo
- Parks
- Residential Communities

NEIGHBORHOOD FEATURES

Population (No. of People)		
.5 mile	1 mile	3 miles
1,961	10,748	102,312

Business (No. of Businesses)		
.5 mile	1 mile	3 miles
134	404	4,121

Employees (No. of Employees)		
.5 mile	1 mile	3 miles
2,238	7,063	67,481

Source: ESRI Business Analysis



Zach Frappier
Director of Realty
701.388.6919 | Zach@EPICCompaniesND.com

